

MEW-170s

注塑机锁模力 Injection Press Range
1000~2000 ton



负载大
Big Payload



高性能
High performance



高稳定性
High Stability



拓星链应用平台
Topstar link application platform

负载大 Big payload

- 姿势部采用大缸径气缸，负载提升，更大型零件搬运；
- 姿势部结构紧凑，可保证在动模取大型产品；
- 搭配大功率伺服驱动和马达，负载能力增大。
- Posture (C axis) uses cylinder with big cylinder diameter to improve payload and extract larger parts.
- The structure of the posture (C axis) is compact, which can ensure taking large products in the moving platen.
- With high-power servo driver and motor, the load capacity increases.

高性能 High performance

- 控制系统自主研发，软件不定期更新，终身可升级，可根据客户需求研发定制；
- 内置双系统客户自由选择；
- 增加各轴软化功能，防止模开距离变动导致取不到产品或撞坏手臂；
- 标配RS485通讯接口，支持MODBUS RTU通讯协议；
- 标配2吸2抱功能，预留11个输入11个输出。
- Control system independent research, irregularly-updated software, can be upgraded for life, can be developed and customized according to customer needs.
- Built-in dual-system, customer-free choice.
- Add the softening function of each axis to prevent robot not picking the products or breaking the arm due to mold opening position changing.
- Standard RS485 communication interface, Support the MODBUS RTU communication protocol.
- Standard 2 vacuum circuit 2 air circuit function, reserve 11 inputs and 11 outputs.

高稳定性 High stability

- 增加振动抑制功能，运行更加平稳；
- 标配储气罐，保证气源稳定，保证产品吸附更加稳定；
- 走行采用加厚方钢提高承载及稳定性；
- Add the vibration suppression function to make machine run more smoothly.
- Standard with gas tanks to ensure stability of gas source and ensure that the product adsorption is more stable.
- Use thickened square steel to improve the carrying and stability of traverse axis.

拓星链应用平台 Topstar link application platform

- 实时远程监控，设备运行数据统计、分析及寿命管理。
- Real-time remote monitoring, data statistics, analysis and life management of equipment operation.

基本参数 Basic Parameters

机型 Model	电源 Power Supply	最大消费电力 Max Power Consumption	使用气压 Air Pressure	空气消费量 Air Consumption	驱动方式 Drive System	姿势(气缸) Posture (Air Cylinder)	最大可搬重量 Max.Load	重复定位精度 Repeated Positioning Accuracy	最小取出时间 Minimum take-out time	空循环时间(不含治具) Dry cycle time (excluding fixtures)	姿势力矩 Posture Torque	本体重量 Net Weight
单位 Unit	V	KW	Mpa	NI/cycle	—	—	kg	mm	s	s	N.m	kg
MEW-170-170-160-25TR	AC220 ±10% 50/60HZ	2.4	0.5~0.7	26	伺服马达/ AC Servo/Motor+ 气缸/ Air Cylinder	90° 固定/ 90° Fixed	20	0.2	3.7	13.2	49.8	1210~1260
MEW-170s-170-160-25TR		3.6	0.5~0.7	26			20	0.2	3.7	13.2	49.8	1360~1410
MEW-170-200-160-30TR		2.4	0.5~0.7	26			20	0.2	4.2	14.2	49.8	1450~1500
MEW-170s-200-160-30TR		3.6	0.5~0.7	26			20	0.2	4.2	14.2	49.8	1600~1650

外形尺寸 Outer dimensions

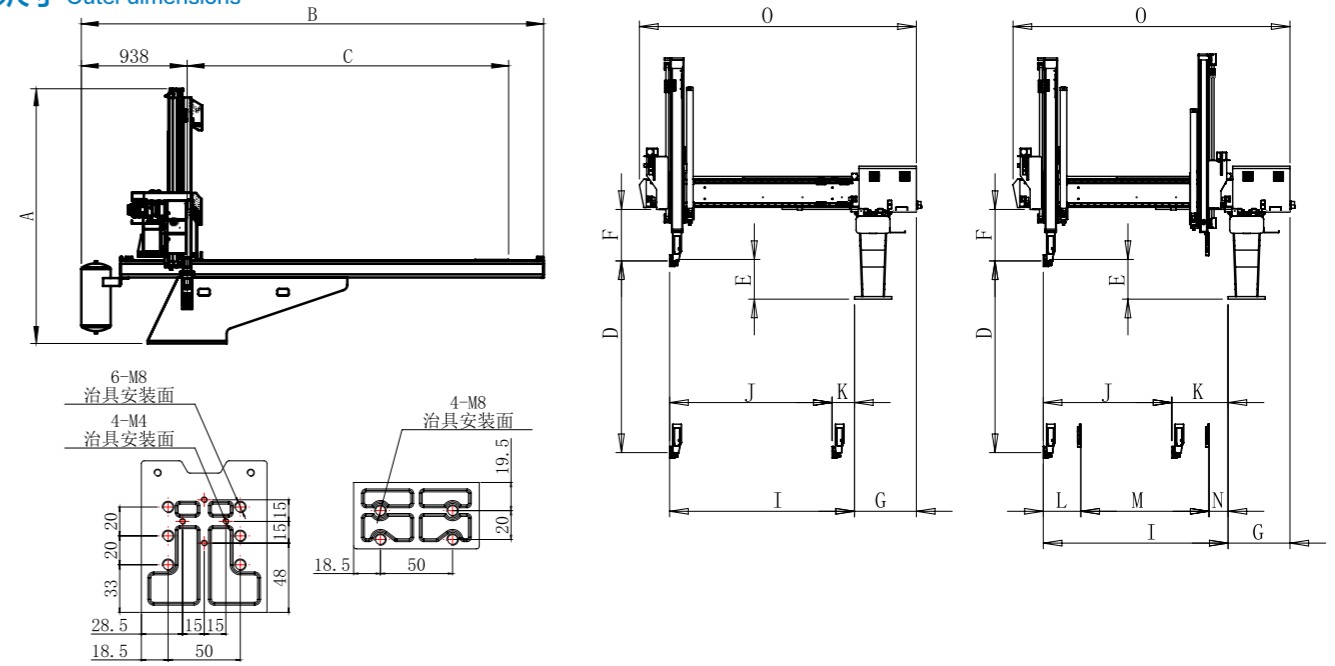

单位: mm Unit: mm	机型 Model	MEW-170-170		MEW-170-200	
		MEW-170-170-160-25TR	MEW-170s-170-160-25TR	MEW-170-200-160-30TR	MEW-170s-200-160-30TR
A	总高 Total height		2175		2295
B	总长 Total length		3620		4100
C	走行行程 Traverse stroke		2500		3000
D	主臂上下行程 Main arm vertical stroke		1700		2000
E	主臂上下待机 Main arm standby height		370		370
F	夹具安装有效空间 Effective space for jig mounting		295		295
G	底座里侧端-箱体末端 Base internal side to end of the box		548		370
H	副臂上下待机 Sub-arm vertical standby	-	410	-	410
I	主臂前进最大值 Main arm max. fwd. movement	1660		1660	
J	主臂前进最大行程 Main arm max. crosswise stroke	1440	1140	1440	1140
K	主臂前后待机最小值 Main arm min. crosswise standby	210	510	210	510
L	主副臂接近最小值 Min. space between main arm and sub-arm	-	350	-	350
M	副臂前进最大行程 Sub-arm max. crosswise stroke	-	1140	-	1140
N	副臂前后待机最小值 Sub-arm min. crosswise standby	-	170	-	170
O	前后臂末端-箱体末端 Crosswise end to box end		2455		2455
P	手臂下降后最小高度 Min. height of arm after descending		1880		1880
Q	治具安装尺寸 Jig mounting dimension	动模面 Moveable platen 40x50,6xM8		定模面 Fixed platen 20X50,4xM8	

注: 正反向尺寸一致 Note: Same dimensions for positive and negative operation models.

配置表 Configuration table

机型 Model	8个独立装箱动作 8 independent packaging motion	自由装箱点(115点×2处) Free packaging motion(115points × 2stage)	落下测下降途中姿势 Posture midway descent at release side	顶针前进后退连动 Ejector Forward and Backward Coordinated Movement	不良品排出口回路 Defective product reject circuit	取出下降待机 Delayed arm descent	水口模内开放 Runner release within mold	输送带启动信号 Start signal of circuit	内部存储记忆(最大100种类型) Internal memory (for Max 100 models)	2国语言切换(中文、英文) Two language exchange (Chinese/English)	Nt剪切·可动侧 NT gate cutting on crossmember of moving	回转单元 Rotation unit	欧规 12 EURO-MAP 12	欧规 67 EURO-MAP 67
MEW-170-170-160-25TR	●	●	●	●	●	●	●	●	●	●	○	○	○	○
MEW-170s-170-160-25TR	●	●	●	●	●	●	●	●	●	●	○	○	○	○
MEW-170-200-160-30TR	●	●	●	●	●	●	●	●	●	●	○	○	○	○
MEW-170s-200-160-30TR	●	●	●	●	●	●	●	●	●	●	○	○	○	○

注: 标配功能“●”、选配功能“○”和“-”表示无。 Note: Standard function "●", optional function "○" and "-" indicates none.